

SURVEY MARKER DESCRIPTION SHEET

A	NAME OF SURVEY: <u>IBEX COORDINATED SURVEY AREA</u>
	SURVEY MARKER NO.: <u>75G01</u> DATE OF SURVEY: <u>August 19, 1975</u>
	TYPE OF SURVEY MARKER: <u>CLS short Standard post cemented in 1.5 metre deep concrete cylinder.</u>
	NTS SHEET: <u>83 J</u> APPROX. LAT.: <u>54° 30' N</u> APPROX. LONG.: <u>134° 15' W</u>

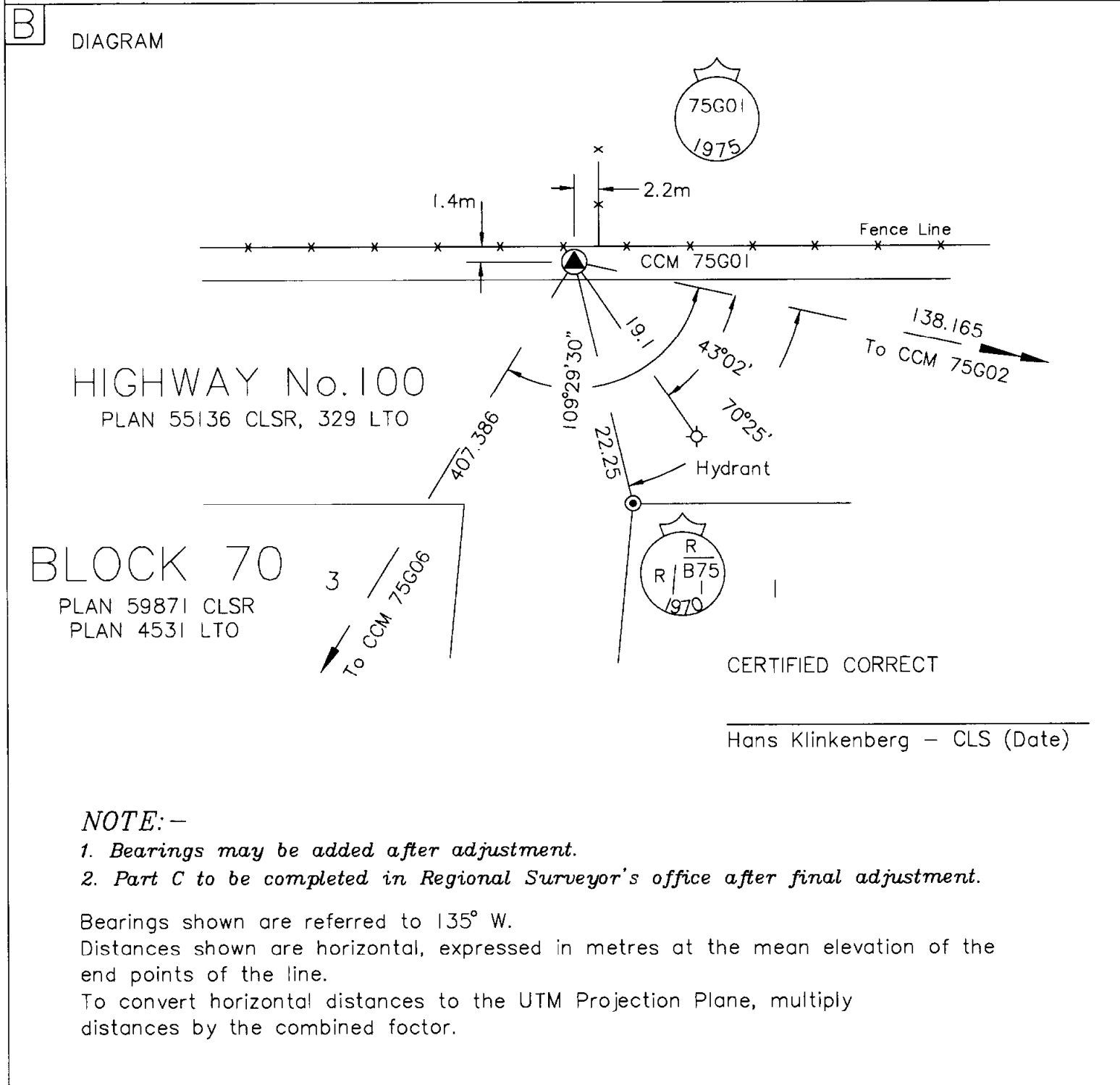

C	COORDINATE SYSTEM: <u>UTM</u> ZONE: <u>8 (135° W.)</u>
	COORDINATES: Northing: _____ Easting: _____ Elevation: _____
	Sea Level Factor: _____ Scale Factor: _____ Combined Factor: _____

Anyone finding a Survey Marker that has been damaged or destroyed is requested to submit a report to the Regional Surveyor. SP 12-3